

Masport[®]
HEATING



CLUTHA

ULTRA-LOW EMISSION (ULEB) WOOD FIRE RANGE

The new Masport Clutha ULEB Wood Fire is inspired by and named after New Zealand's second longest river. The Clutha river is famous for its swift-flowing turquoise, ultra-clean water originating from the glaciers. Similarly, the Clutha Wood Fire has a contemporary design suitable for small to medium homes and ultra-clean burning, making it ideal for homes with a wide range of decors throughout New Zealand.



masportheating.co.nz

CLUTHA ULTRA-LOW EMISSION (ULEB) WOOD FIRE RANGE

The Clutha Wood Fire has a portrait orientation, a compact footprint, and an expansive viewing window to see the fire inside. The Clutha is fitted with Ceramic Fire Bricks and Stainless Steel Boxed Baffle; both provide best-in-class performance and durability, ensuring unrivaled performance and low maintenance, which lowers running costs over the life of the fire.

- ▶ Ultra-clean burning that is better for air quality
- ▶ Large portrait window with an expansive flame view
- ▶ Three base options to suit your needs and taste
 - Concealed, easy clean Ash Pan base
 - Convenient wood storage solution with Wood Stacker base
 - Pedestal only base
- ▶ Small footprint ideal for small spaces
- ▶ Ceramic Fire Bricks for greater heat retention and durability
- ▶ Stainless Steel Boxed Baffle for superior performance and longevity
- ▶ Lower long-term running costs due to quality components
- ▶ Start-Up Latch mechanism for ease of operation and safety
- ▶ Does not require electricity
- ▶ A future proof solution for all NZ regions - clean air zones and rural installations



Finish	Metallic Black VHT
Space Heat Output***	Suitable for Small to Medium homes (2-3 bedrooms)
Dimensions w x d x h	495 x 524 x 894mm

BASE OPTIONS



Fire Only	999916	999921	999922
Flue Only	GDFLU013M	GDFLU013M	GDFLU013M
Fire & Flue Pack	CLUTHAPEDPACK	CLUTHAASHPACK	CLUTHAWSPACK

Ultra M³ TECHNOLOGY

Ultra M3 technology incorporates a fusion of 3 key features to elevate the performance, clean burning, safety and lower maintenance costs.



Future proof your purchase to protect the New Zealand natural environment.

Clearance Specifications

Minimum distance to heat sensitive materials (mm) when a Masport double skin flue shield is fitted as per Masport specifications.

Model	Space Heat Output	Type of Flue Shield	Type of Floor Protector	A	B	C	D	E	F	G	H	I	J	K	L	M	N	R	W
Clutha Ped / Ash / Woodstacker	SML-MED	MDSM	AFP	83	325	300	117	144	246	573	384	428	729	902	1199	998	656	543	495

Flue Shields

MDSM Masport Double Skin Flue Shield 900mm long with special heat diverter and ceiling plate

Floor Protectors

AFP Ash Floor Protector

Masport Steel Floor Protectors

Parallel - 998901 & 998908
Corner - 998904 or 998909

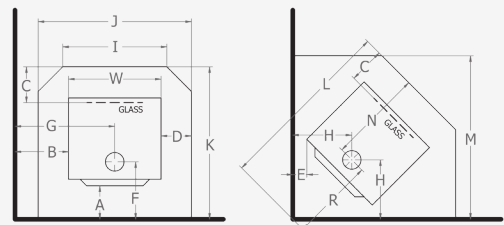

* Refer to the specification sheet for full details of the clearance distances and heat capacity and output.

**Space Heat Output is only a guide based on homes with average insulation, window area, and 2.4m ceiling heights. Differences in these factors, as well as others like, geographical location, layout of the house, living room size, type of windows all play a part in choosing the right model for your heating needs. Consult your dealer or installation contractor for more information.



Glen Dimplex New Zealand Ltd PO Box 58473, Botany, Auckland

Glen Dimplex New Zealand Ltd's policy is one of continuous development. We reserve the right to change size and specifications without notice. For the latest product information and warranty details please refer to www.masportheating.co.nz. Please refer to the installation and operation instructions before having your Masport Wood Fire installed. A full set of these instructions is supplied with each fire.